

TECHNICAL DETAILS: ROCKY MOUNTAIN HARDWARE[®]

ROCKY MOUNTAIN HARDWARE CURVED ESCUTCHEON

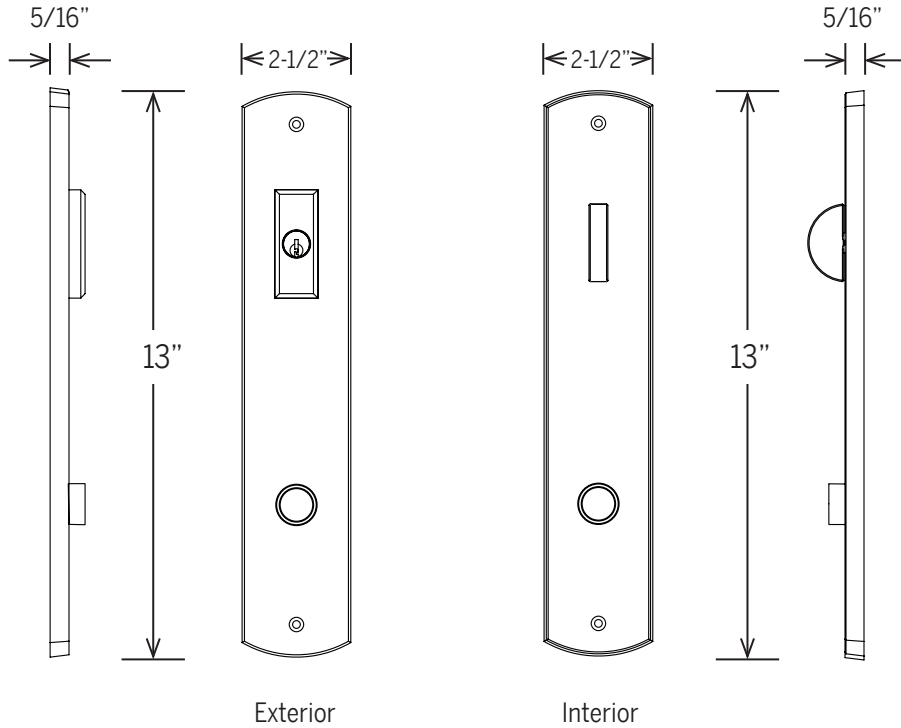

Exterior

Interior

Requires 2-1/8" \varnothing
Crossbores

FINISHES

-  Silicon Bronze Light
-  Silicon Bronze Medium
-  Silicon Bronze Dark
-  Silicon Bronze Rust
-  Silicon Bronze Brushed
-  White Bronze Light
-  White Bronze Medium
-  White Bronze Dark
-  White Bronze Brushed

**CURVED
HANDLE SET**

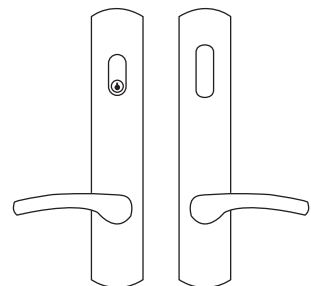

TECHNICAL DETAILS: ROCKY MOUNTAIN HARDWARE[®]

ROCKY MOUNTAIN HARDWARE RECTANGULAR ESCUTCHEON

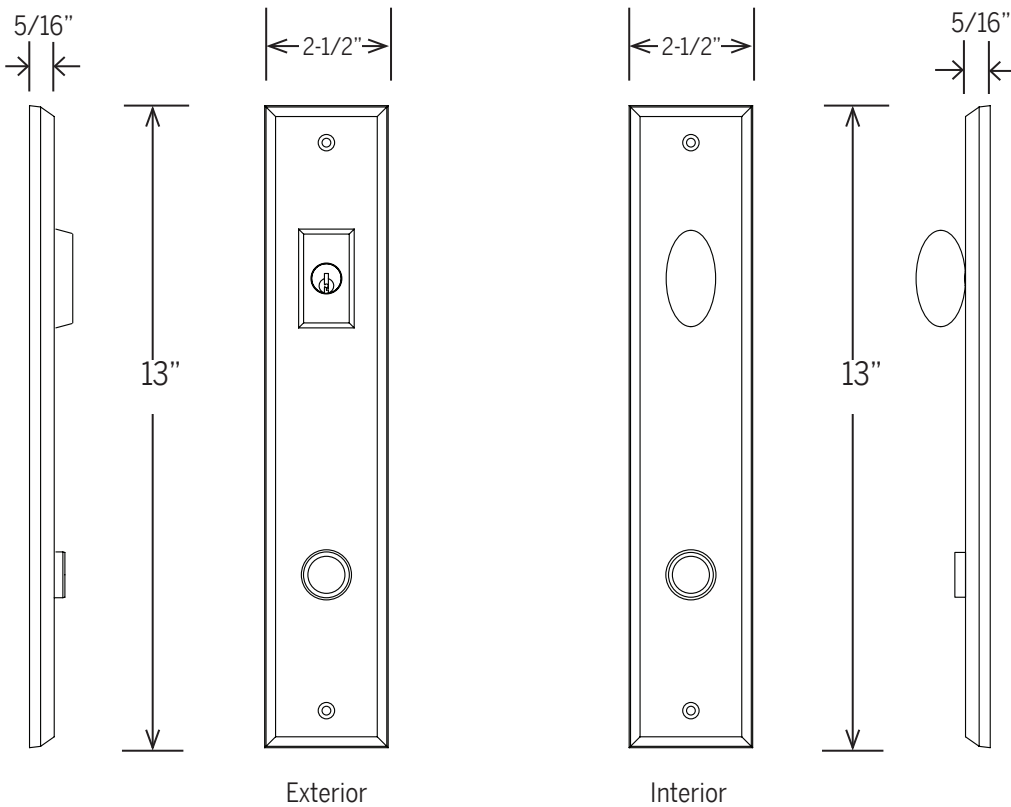

Requires 2-1/8" \varnothing
Crossbores

FINISHES	
	Silicon Bronze Light
	Silicon Bronze Medium
	Silicon Bronze Dark
	Silicon Bronze Rust
	Silicon Bronze Brushed
	White Bronze Light
	White Bronze Medium
	White Bronze Dark
	White Bronze Brushed

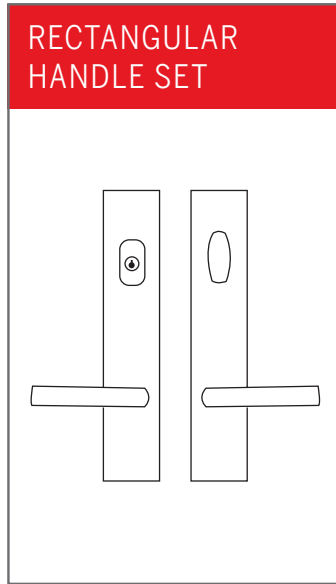

TECHNICAL DETAILS: ROCKY MOUNTAIN HARDWARE[®]

ROCKY MOUNTAIN HARDWARE STEPPED ESCUTCHEON

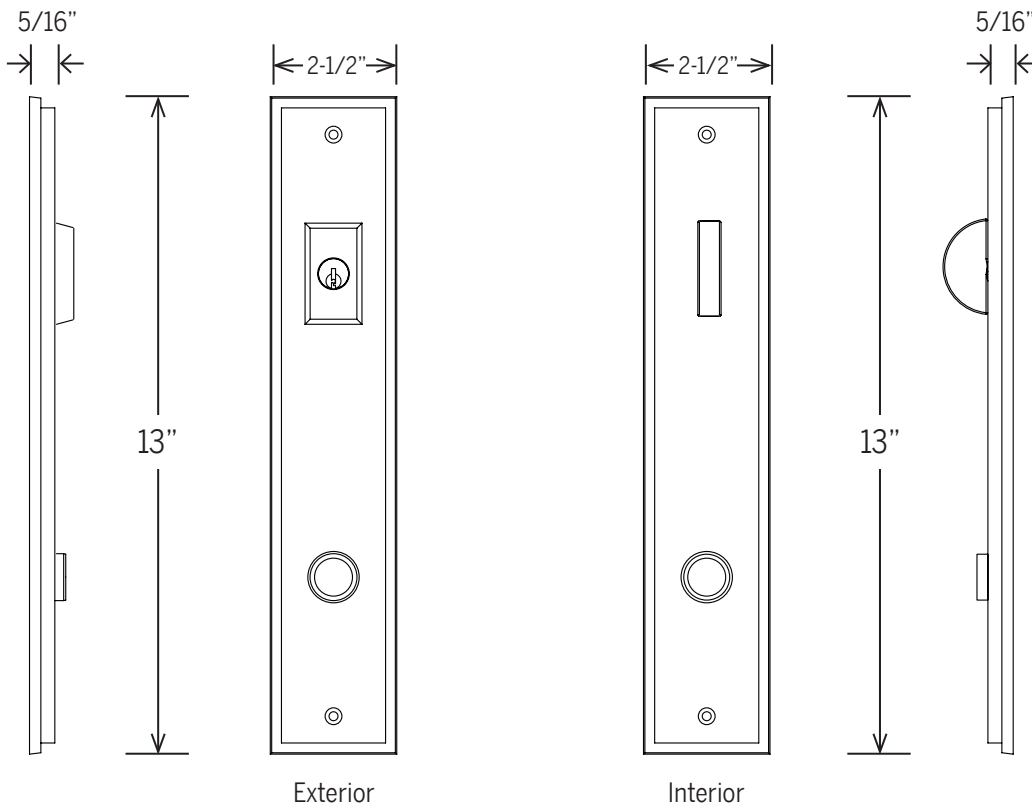

Exterior

Interior

Requires 2-1/8" \varnothing
Crossbores

FINISHES

-  Silicon Bronze Light
-  Silicon Bronze Medium
-  Silicon Bronze Dark
-  Silicon Bronze Rust
-  Silicon Bronze Brushed
-  White Bronze Light
-  White Bronze Medium
-  White Bronze Dark
-  White Bronze Brushed

STEPPED HANDLE SET

Diagram of the stepped handle set, showing two vertical plates with horizontal handles. The left plate has a circular hole at the top, and the right plate has a rectangular hole at the top. Both plates have a horizontal handle extending from the bottom.

TECHNICAL DETAILS: ROCKY MOUNTAIN HARDWARE[®]

ROCKY MOUNTAIN HARDWARE ARCHED ESCUTCHEON

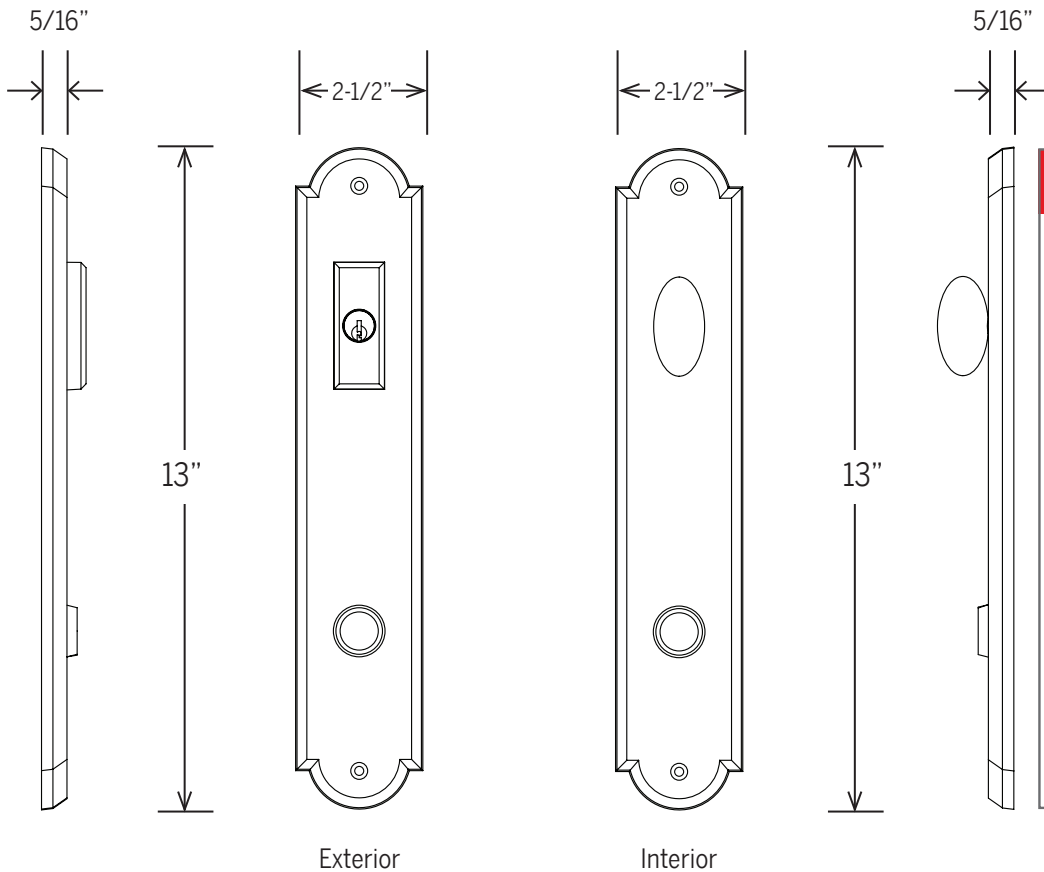

Exterior

Interior

Requires 2-1/8" \varnothing
Crossbores

FINISHES	
	Silicon Bronze Light
	Silicon Bronze Medium
	Silicon Bronze Dark
	Silicon Bronze Rust
	Silicon Bronze Brushed
	White Bronze Light
	White Bronze Medium
	White Bronze Dark
	White Bronze Brushed

ARCHED HANDLE SET

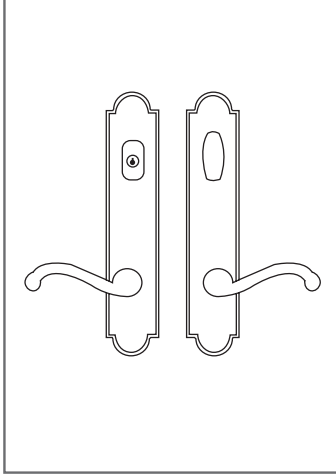

TECHNICAL DETAILS: ROCKY MOUNTAIN HARDWARE[®]

ROCKY MOUNTAIN HARDWARE FLEUR DE LIS ESCUTCHEON

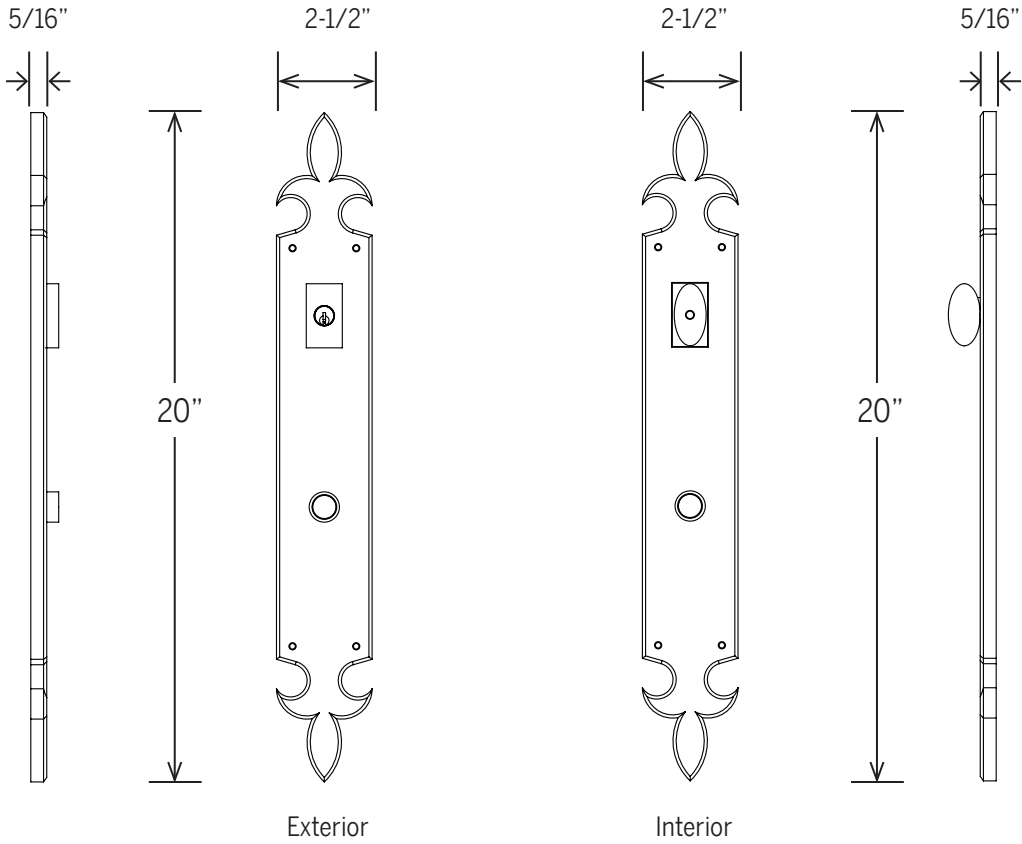

Requires 2-1/8" \emptyset
Crossbores

FINISHES	
	Silicon Bronze Light
	Silicon Bronze Medium
	Silicon Bronze Dark
	Silicon Bronze Rust
	Silicon Bronze Brushed
	White Bronze Light
	White Bronze Medium
	White Bronze Dark
	White Bronze Brushed

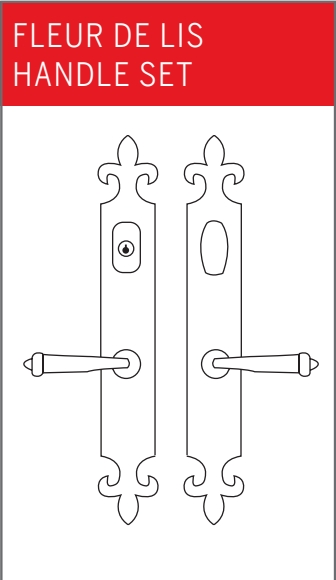

TECHNICAL DETAILS: ROCKY MOUNTAIN HARDWARE[®]

ROCKY MOUNTAIN HARDWARE EXTERIOR ENTRANCE GRIPS (SECTIONAL)

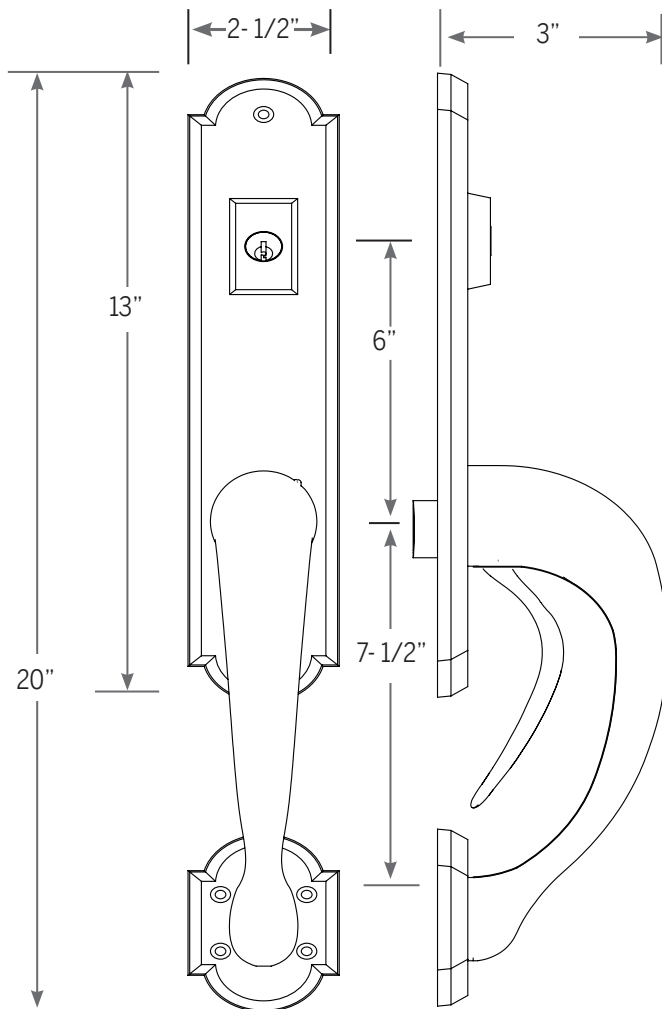

Requires 2-1/8" \varnothing Crossbores

FINISHES

-  Silicon Bronze Light
-  Silicon Bronze Medium
-  Silicon Bronze Dark
-  Silicon Bronze Rust
-  Silicon Bronze Brushed
-  White Bronze Light
-  White Bronze Medium
-  White Bronze Dark
-  White Bronze Brushed

ARCHED HANDLE GRIP

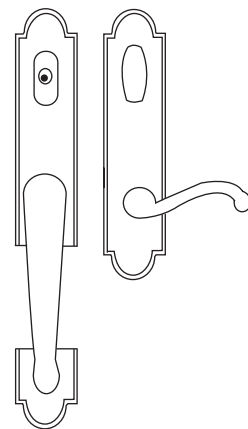

TECHNICAL DETAILS: ROCKY MOUNTAIN HARDWARE[®]

ROCKY MOUNTAIN HARDWARE EXTERIOR ENTRANCE GRIPS (FULL LENGTH)

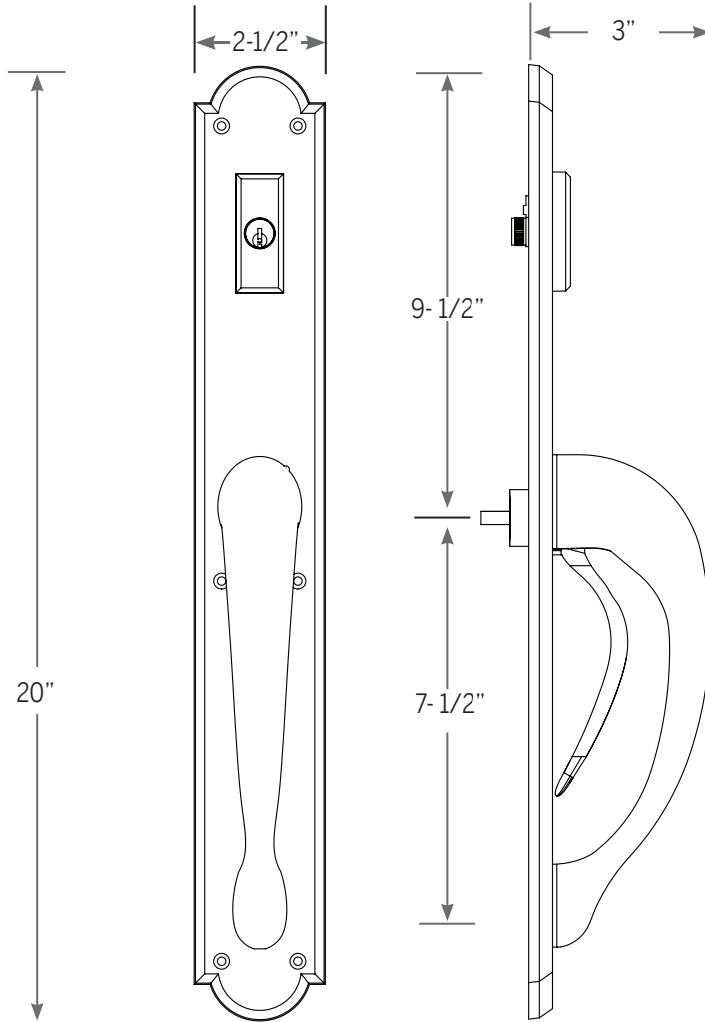

Requires 2-1/8" \varnothing
Crossbores

FINISHES

- Silicon Bronze Light
- Silicon Bronze Medium
- Silicon Bronze Dark
- Silicon Bronze Rust
- Silicon Bronze Brushed
- White Bronze Light
- White Bronze Medium
- White Bronze Dark
- White Bronze Brushed

ARCHED HANDLE GRIP

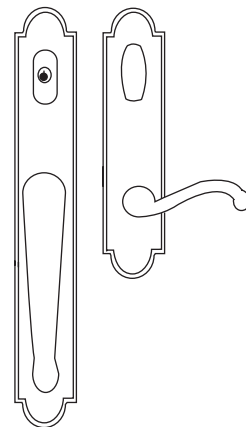

TECHNICAL DETAILS: ROCKY MOUNTAIN HARDWARE[®]

EACH ESCUTCHEON MAY BE COMBINED WITH ANY OF THE FOLLOWING LEVERS AND IS AVAILABLE IN YOUR CHOICE OF NINE PATINA FINISHES.

LEVER OPTIONS



L127
SCROLL LEVER
IN SILICON
BRONZE, DARK



L101
LONGHORN LEVER
IN SILICON
BRONZE, RUST



L110
CLASSIC LEVER
IN SILICON BRONZE,
MEDIUM



L130
MONARCH LEVER
IN WHITE BRONZE,
MEDIUM



L102
SQUIRREL TAIL
LEVER IN SILICON
BRONZE, LIGHT



L111
TWIG LEVER
IN SILICON BRONZE,
RUST



L132
SQUARE TWIST
LEVER IN WHITE
BRONZE, LIGHT



L103 M, L112 L
CHUB LEVER
IN WHITE
BRONZE, MEDIUM



L115 M, L158 L
ACANTHUS LEVER
IN SILICON BRONZE,
MEDIUM



L135
OLYMPUS LEVER
IN WHITE BRONZE,
LIGHT



L104
HOOK LEVER
IN SILICON
BRONZE, RUST



L117
FRENCH LEVER
IN SILICON BRONZE,
DARK



L140
HARRINGTON LEVER
IN SILICON
BRONZE, MEDIUM



L105
BEAVER TAIL LEVER
IN SILICON
BRONZE, RUST



L118
FRENCH TWIST
LEVER IN SILICON
BRONZE, RUST



L150
BELLA LEVER
IN SILICON
BRONZE, DARK



L106
TALON LEVER IN
SILICON BRONZE,
LIGHT



L121 M, L141 L
ROCK CREEK LEVER
IN WHITE
BRONZE, MEDIUM



L160
WING LEVER
SILICON BRONZE,
LIGHT



L107
SLUGGER LEVER
IN SILICON BRONZE,
MEDIUM



L123
OLD WORLD LEVER
IN WHITE
BRONZE, MEDIUM



L163
EURO LEVER
IN SILICON
BRONZE, MEDIUM



L108
TUBE LEVER
IN WHITE BRONZE,
LIGHT



L125
CLASSIC SCROLL
LEVER IN WHITE
BRONZE, MEDIUM



L224
RIDGE LEVER
IN SILICON
BRONZE, MEDIUM



L109 M, L119 L
LEGACY LEVER
IN SILICON
BRONZE, MEDIUM



L126
TRIPLE TWIST
LEVER IN WHITE
BRONZE, LIGHT



L580
MADDOX LEVER
IN WHITE
BRONZE, MEDIUM



L174
LARIAT LEVER
IN SILICON
BRONZE, DARK



L175
BAMBOO LEVER
IN SILICON BRONZE,
MEDIUM



L276
FALCON LEVER
IN WHITE
BRONZE, MEDIUM



L301
STRAP LEVER
IN SILICON
BRONZE, BRUSHED



L304
REED LEVER
IN WHITE BRONZE,
BRUSHED



L307
JANE LEVER
IN SILICON BRONZE,
DARK



L310
POOL LEVER
IN WHITE BRONZE,
LIGHT



L314
UJ LEVER
IN SILICON BRONZE,
DARK

LEVER SPECIFICATIONS

L101 Longhorn Lever

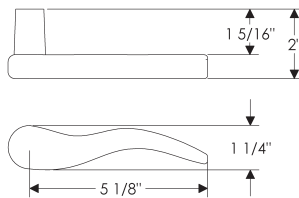

L105 Beaver Tail Lever

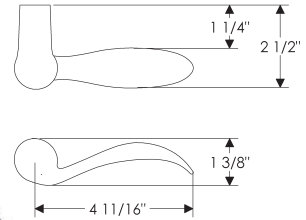

L102 Squirrel Tail Lever

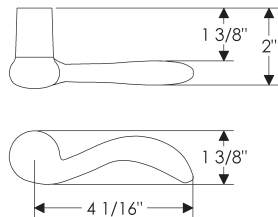

L106 Talon Lever

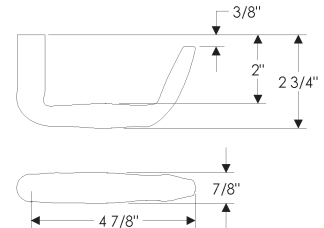

L103 Chub Lever

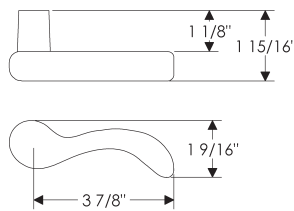

L107 Slugger Lever

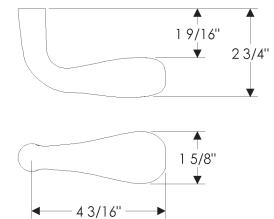
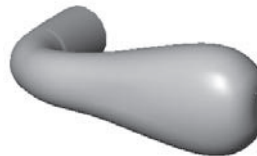

L104 hook lever

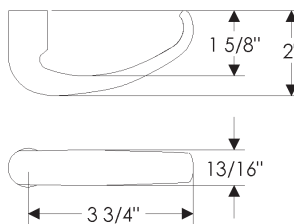

L108 Tube Lever

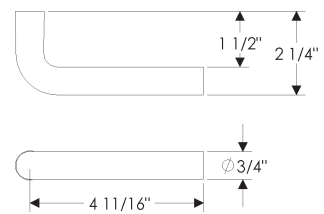
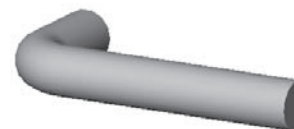

TECHNICAL DETAILS: ROCKY MOUNTAIN HARDWARE[®]

LEVER SPECIFICATIONS

L109 Legacy Lever

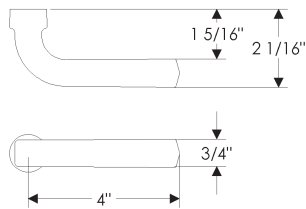
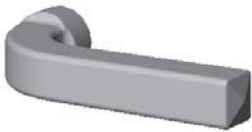

L115 Acanthus Lever

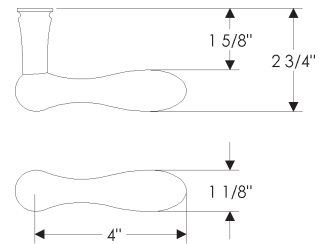

L110 Classic Lever

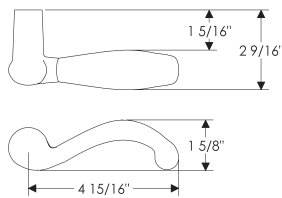

L117 French Lever

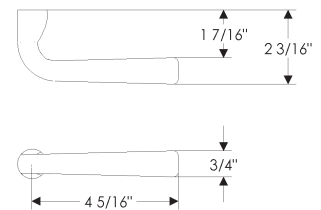
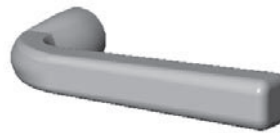

L111 Twig Lever

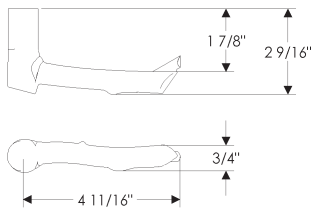

L118 French Twist Lever

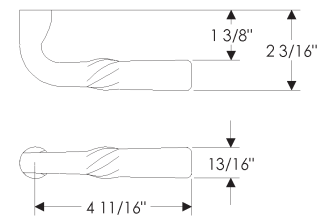
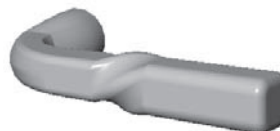

L112 Larger Chub Lever

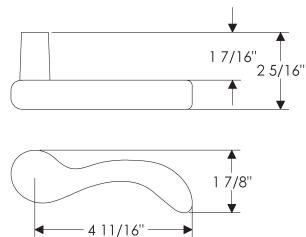

L119 Long Legacy Lever

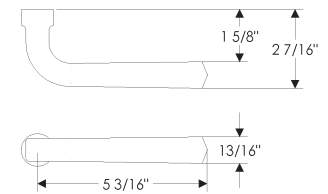
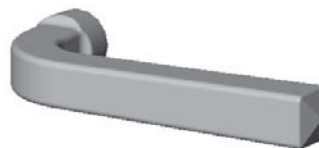

TECHNICAL DETAILS: ROCKY MOUNTAIN HARDWARE[®]

LEVER SPECIFICATIONS

L121 Rock Creek Lever

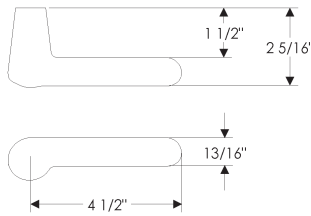
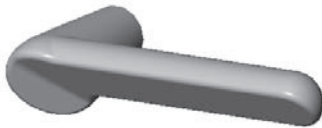

L127 Scroll Lever

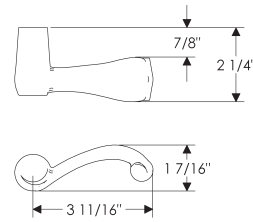

L123 Old World Lever

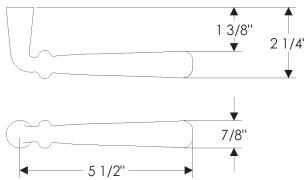
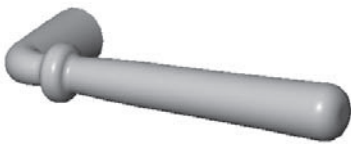

L130 Monarch Lever

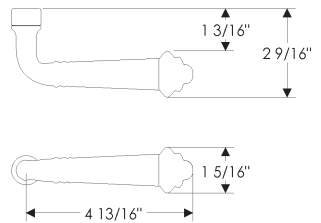
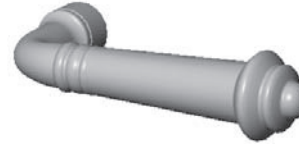

L125 Classic Scroll Lever

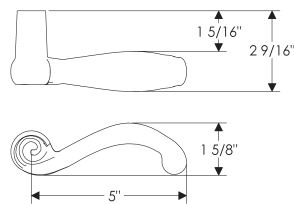

L132 Square Twist Lever

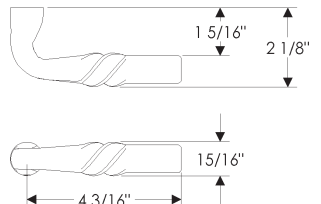
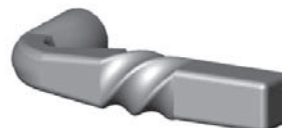

L126 Triple Twist Lever

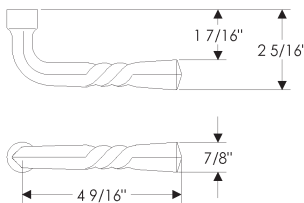
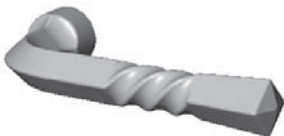

L135 Olypus Lever

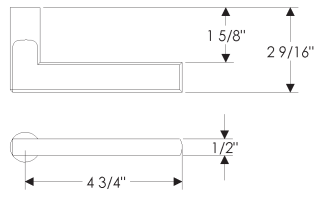
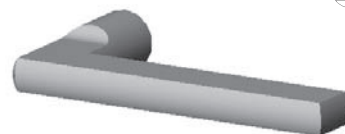

TECHNICAL DETAILS: ROCKY MOUNTAIN HARDWARE[®]

LEVER SPECIFICATIONS

L140 Harrington Lever

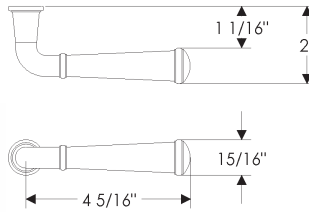

L160 Wing Lever

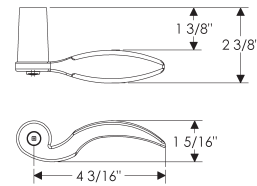

L141 Large Rock Creek Lever

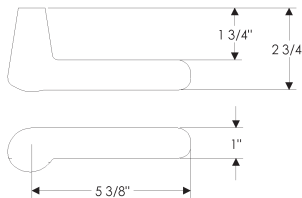
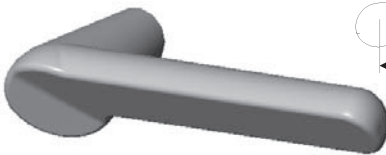

L163 Euro Lever

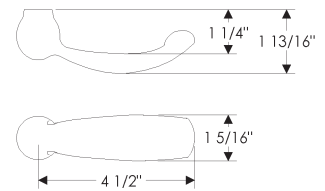
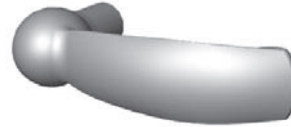

L150 Bella Lever

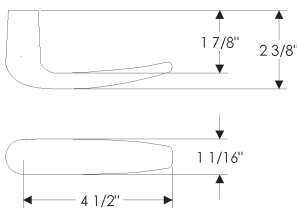

L174 Lariat Lever

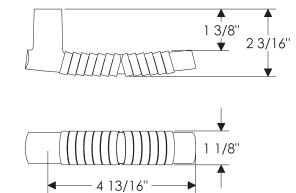
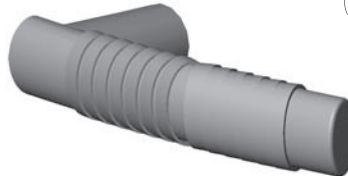

L158 Large Acanthus Lever

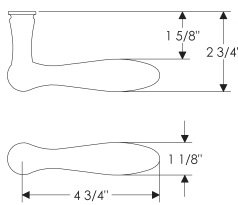
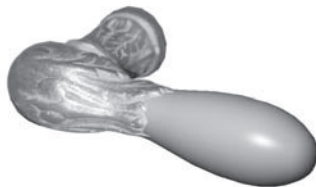

L175 Bamboo Lever

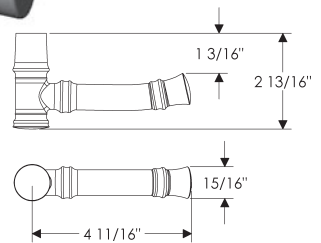
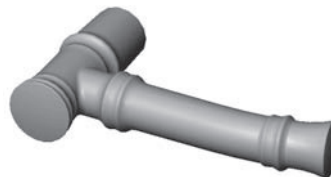

TECHNICAL DETAILS: ROCKY MOUNTAIN HARDWARE[®]

LEVER SPECIFICATIONS

L224 Ridge Lever

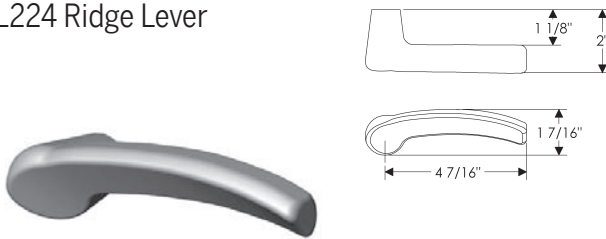

L307 Jane Lever

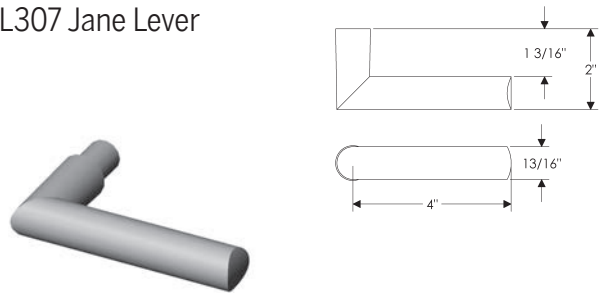

L276 Falcon Lever

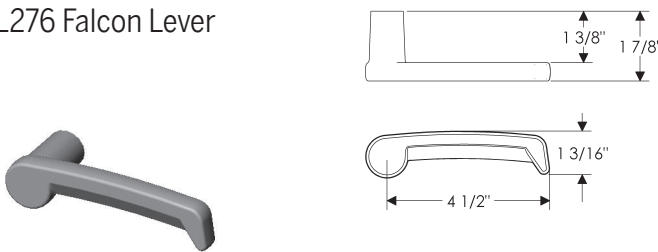

L310 Pool Lever

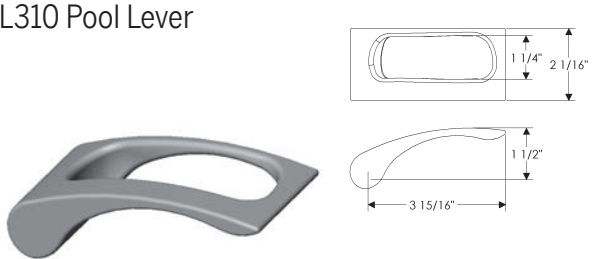

L301 Strap Lever

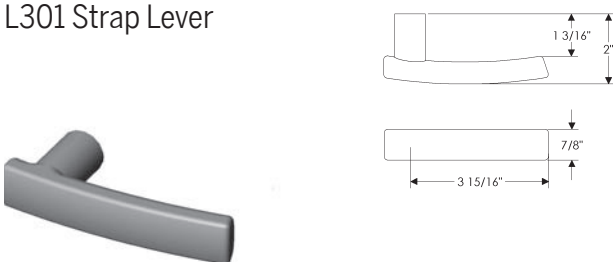

L314 UJ Lever

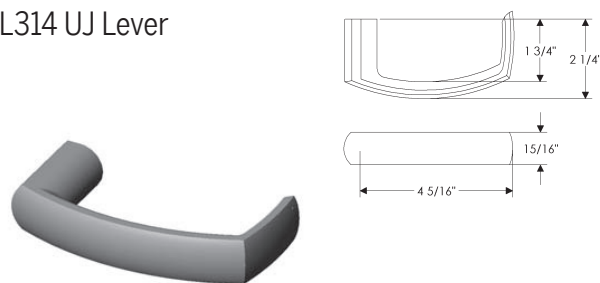

L304 Reed Lever

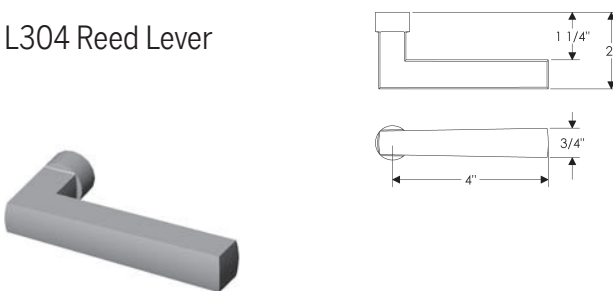

L590 Maddox Lever

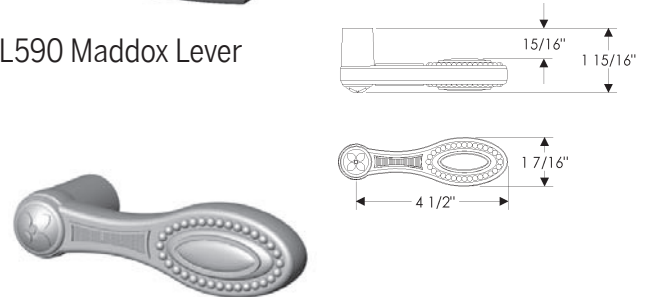

U.S. Patents 5,524,941; 5,524,942; 7,753,418

The information contained in this document is the confidential and proprietary information and trade secrets of Endura Products, Inc. Any disclosure, use or dissemination of such information without the express written permission of Endura Products, Inc. is strictly prohibited. Endura Products, Inc. also owns any and all intellectual property rights embodied in such information, including patent rights, copyrights, and trademark rights, and no license of any intellectual property right is intended, nor should any license be implied, as a result of the receipt of this document.

Rev. 1.13